



The BCL series present lobe rotor pumps designed according to the EHEDG specifications that comply with the strictest hygienic requirements of the biotechnology and pharmaceutical industry.

The applications include pumping of viscous as well as low-viscous media that require a gentle transfer. These pumps are also used in the applications requiring perfect cleanness and sterilisation by CIP/SIP processes.

The aseptic version is especially indispensable for the applications where a sterile pumped product is to be safe from any contamination.

### Operating principle

The SLR pumps basically consist of two lobe rotors which rotate synchronously inside a casing without touching each other.

As the rotors rotate, the spaces between the lobes and the casing are successively filled with fluid, which is transported to the discharge nozzle with a fixed amount of displacement. The pumped fluid forms a continuous stream thanks to the tolerances between the lobes and the pump casing, thus ensuring an efficient pumping.

The operating principle is exactly the same as the one of the SLR lobe rotor pump.

Moreover, the pump is completely drainable as it is mounted vertically.

Apart from a double mechanical seal aseptic design pumps have steam barriers at the front cover as well as at the clamp connections of the inlet and outlet of the pump.

Thus all places where the product may have contact with the atmosphere have barriers.

### Design and features

Vertical support. Completely drainable pump.

Clamp connections.

Tri-lobe rotors.

Interior surface roughness  $Ra < 0.5 \mu m$ .

EPDM gaskets according to FDA 177.2600 normative.

Hygienic single mechanical seal.

Parts in contact with the media: AISI 316L.

The assembly of the lobes is effected without screws in contact with the media.

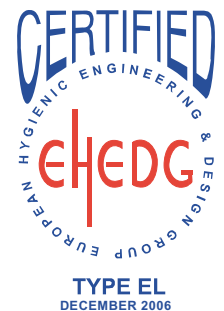

### Materials

Parts in contact with the media:

AISI 316L

Support:

GG-15

Gaskets (standard)

EPDM in compliance with FDA

Mechanical seal (standard)

SiC/SiC/EPDM



## Options

Single mechanical seal SiC/C/EPDM

Single cooled mechanical seal (quench)

Back to back mechanical seal

FPM and PTFE gaskets

Aseptic version:

steam barrier at the pump cover

steam barriers at the pump inlet and outlet connections

double mechanical seal SiC/SiC/EPDM-SiC/C/EPDM

Traceability and Certification of the materials EN 10204 3.1

Surface finish certificate

ATEX design available

Stainless steel support (CF-8)

## Technical specifications

Max. flow 40 m<sup>3</sup>/h

Max. head 10 bar

Max. working temperature 120 °C

Max. speed 950 rpm

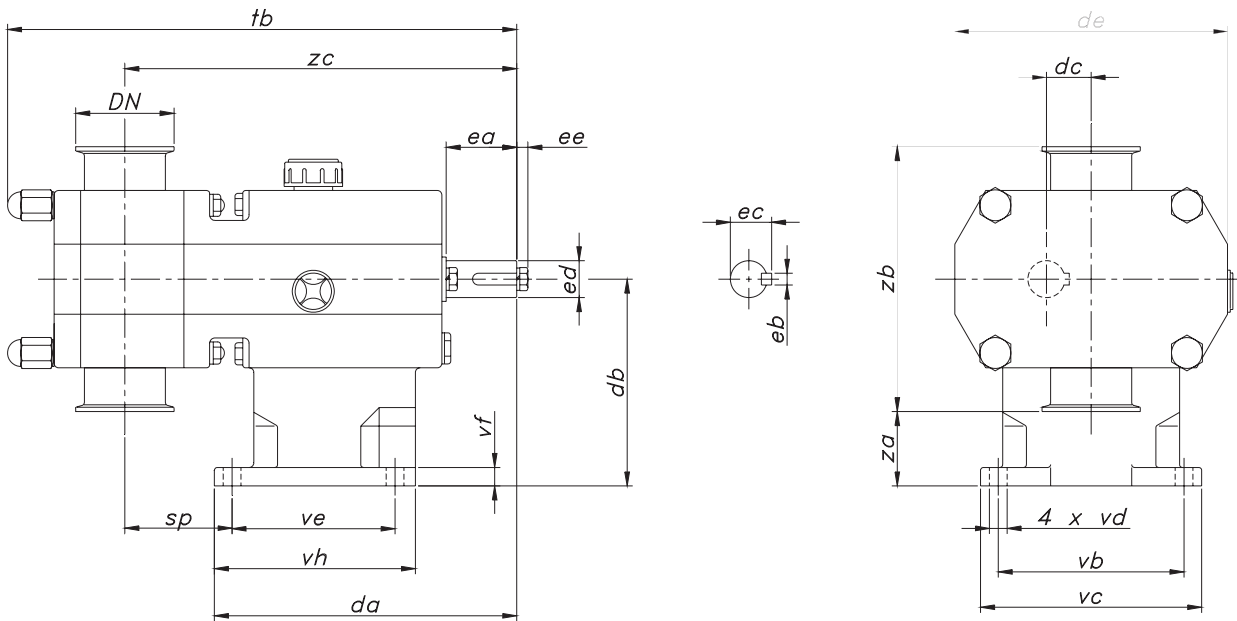
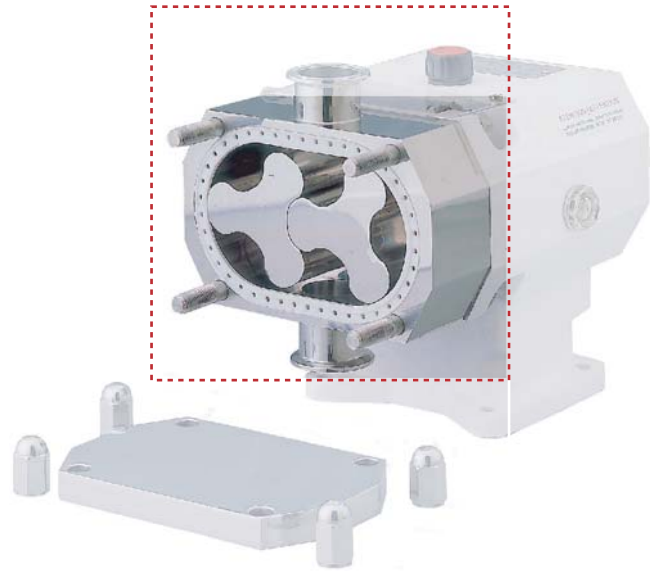

BCL	DN	da	db	dc	de	ea	eb	ec	ed	ee	sp	tb	vb	vc	vd	ve	vf	vh	za	zb	zc
1-25	1"	165	112	25	160	40	6	21,6	19	6	71	287	115	135	9	85	10	105	31	162	225
1-40	1 1/2"										77	299									231
2-40	1 1/2"	200	140	31	190	50	8	27	24	8	76	339	125	150	11	105	12	130	51,5	177	263
2-50	2"										82	351									269
3-50	2"	280	190	46,5	250	80	10	41,4	38	12	91	430	170	210	13	130	14	170	74	232	348
3-80	3"										101	452									360

FTBCL.1.EN-0307

---

## Насосы — Роторный насос BCL

<http://k-tep.com.ua/>

✉ [k-tep@ukr.net](mailto:k-tep@ukr.net)

■ Office +38 044 2091823

■ МТС +38 066 9076563

■ Киевстар +38 098 3676414

Skype: [k-teppumps](#)

### **Замечания**

*Условия поставки: DDP склад г. Киев*

#### **Заметки**

Время поставки рассчитано согласно дате предложения и изменяется в зависимости от даты подтверждения заказа.

Помещая заказ, Покупатель принимает предложение и все спецификации, характеристики и условия, указанные в данном документе.