



Clamp Fittings





Высокое качество фитингов для успеха фармацевтического процесса

ПРОДУКТ

Фитинги из нержавеющей стали соответствуют стандартам ASME BPE. Все соединения уплотняющих прокладок соответствуют критериям FDA, а некоторые составляющие также были сертифицированы и приняты Министерством сельского хозяйства США, 3-A санитарный стандарт и сертификаты USP класса VI.

МАТЕРИАЛ

Фитинги изготовлены из нержавеющей стали AISI 316L (EN 1.4404 - 1.4435). Сера контролируется от 0,005 до 0,017% на всех концах сварного шва, что позволяет выполнять высококачественный процесс орбитальной сварки. Наибольшее влияние на качество сварного шва оказывает сера.

РАЗМЕРЫ

Фитинги из нержавеющей стали размером от ½" до 4" в стандартной комплектации. Большие размеры доступны по запросу.

РАЗМЕРЫ И ДОПУСКИ

Размеры согласно ASTM A270 Допуск по ASTM A269 или как указано в ASME BPE Part DT - Таблица DT-5 * (* только для фитингов BPE)

ПОВЕРХНОСТЬ

Внутренняя отделка фитингов из нержавеющей стали соответствует стандарту ASME BPE std. как указано в ASME BPE Part SF - Таблица SF-4. код обозначения поверхности SFF2. Механическая обработка состоит из абразивной полировки. Внешняя поверхность: scotchbrite.

МАРКИРОВКА

Каждый фитинг обозначается следующим: номер партии, размер, марка стали, производитель.

МАТЕРИАЛ

Сертификаты (MTR) поставляются вместе с арматурой.

TOLERANCES TABLE DT- 5

Final tolerances for mechanically polished fittings and process components

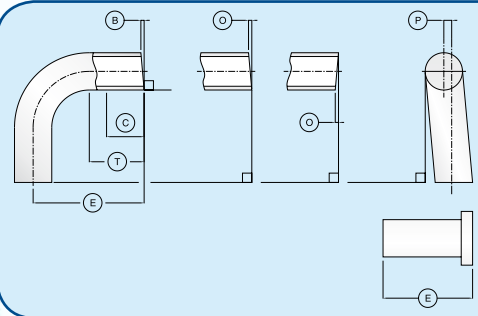

Nominal Size	OD mm	Wall thickness mm	Squareness face to tangent, B mm	Off Angle, O mm	Off Plane, P mm
1/2"	±0,13	+0,13/-0,20	0,13	0,36	0,36
3/4"	±0,13	+0,13/-0,20	0,13	0,46	0,46
1"	±0,13	+0,13/-0,20	0,20	0,64	0,64
1"1/2	±0,20	+0,13/-0,20	0,20	0,86	0,86
2"	±0,20	+0,13/-0,20	0,20	1,09	1,09
2"1/2	±0,25	+0,13/-0,20	0,25	1,37	1,37
3"	±0,25	+0,13/-0,20	0,41	1,73	1,73
4"	±0,38	+0,20/-0,25	0,41	2,18	2,18
6"	±0,76	+0,20/-0,38	0,76	3,43	3,4

GENERAL NOTE: tolerances on E end-to-end, center-to-end: 1,27 mm.
The length of the control portion C is fixed for all size at 19 mm.

Quality

SURFACE FINISH TABLE SF- 4 Ra readings for fittings

ASME BPE Surface designation	INSIDE SURFACE		Surface treatment
	Ra Average μm	Ra Maximum μm	
SFF1	0,375	0,5	Mechanically polished
SFF2	0,5	0,625	Mechanically polished
SFF3	0,625	0,75	Mechanically polished
SFF4	0,25	0,375	Mech.pol. & Electropoli.
SFF5	0,375	0,5	Mech.pol. & Electropoli.
SFF6	0,5	0,625	Mech.pol. & Electropoli.

GENERAL NOTE: All Ra readings are taken across the lay, wherever possible.
The average Ra is derived from readings taken at four cross sections approximately 90 ° apart. No single reading exceeding Ra max.



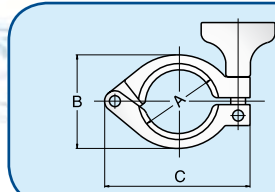

size	A	B	C	Gr.	code
1/2"	28,0	35,0	51,0	140	13MHHS-1/2"
3/4"	28,0	35,0	51,0	140	13MHHS-3/4"

code **13MHHS - FRACTIONAL**

Clamp in misura unica - *One size accomodates 1/2" and 3/4"*

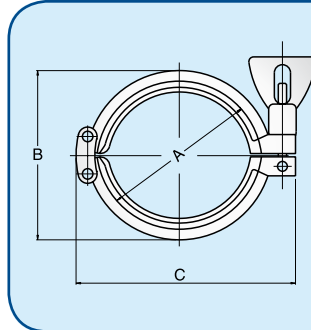

size	A	B	C	Gr.	code
1"	54,0	67,0	86,0	225	13MHHM-1"
1 1/2"	54,0	67,0	86,0	225	13MHHM-1 1/2"
2"	67,5	81,0	101,0	295	13MHHM-2"
2 1/2"	81,0	94,0	114,0	340	13MHHM-2 1/2"
3"	94,5	105,0	126,0	450	13MHHM-3"
4"	122,5	134,0	156,0	500	13MHHM-4"
6"	170,0	185,0	216,0	1150	13MHHM-3"
8"	221,0	235,0	270,0	1500	13MHHM-4"
10"	271,0	285,0	325,0	1750	13MHHM-3"
12"	322,0	340,0	380,0	2100	13MHHM-4"

code **13MHHM**

Clamp a due settori con doppio snodo - *Double pin heavy duty clamp Size 1" @*

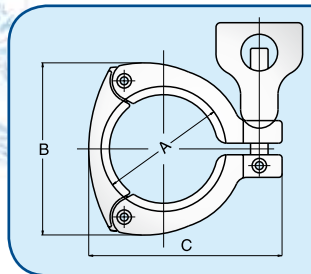

size	A	B	C	Gr.	code
1"	52,0	69,0	80,0	400	13MHHS-1"
1 1/2"	52,0	69,0	80,0	400	13MHHS-1 1/2"
2"	65,5	82,0	95,0	450	13MHHS-2"
2 1/2"	79,0	97,0	105,0	500	13MHHS-2 1/2"
3"	92,5	109,0	125,0	600	13MHHS-3"
4"	120,5	133,0	155,0	750	13MHHS-4"

code **13MHHS**

Clamp a 3 settori - *3 Pieces heavy duty clamp Size 1" @ 4"*

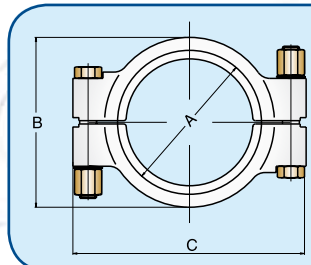

size	A	B	C	Gr.	code
3/4"	28,0	37,0	55,0	150	13MHP-3/4"
1"	52,0	69,0	103,0	500	13MHP-1"
1 1/2"	52,0	69,0	103,0	500	13MHP-1 1/2"
2"	65,5	82,0	115,0	750	13MHP-2"
2 1/2"	79,0	97,0	128,0	800	13MHP-2 1/2"
3"	92,5	109,0	141,0	900	13MHP-3"
4"	120,5	133,0	167,0	1050	13MHP-4"

code **13MHP**

Clamp per alte pressioni - *High pressure clamp Size 3/4" @ 4"*

PRESSIONI max di esercizio in Kg/cm² - *bar Service Rating*



tubo OD	1/2"-3/4"	1"	1 1/2"	2"	2 1/2"	3"	4"
13MHHM	coppia serraggio galletto - <i>wing nut tightened to = 2,8 Nm of torque</i>						
@ 21 °C	152	34	34	31	28	24	21
@ 121 °C	82,7	21	21	21	14	13	10
13MHHS	coppia serraggio galletto - <i>wing nut tightened to = 2,8 Nm of torque</i>						
@ 21 °C		41	41	38	31	24	21
@ 121 °C		21	21	19	15	12	10
13MHP	coppia serraggio bulloni - <i>bolt tightened to = 27,1 Nm of torque</i>						
@ 21 °C		207	103	69	69	69	55
@ 121 °C		83	83	55	55	55	41

Le pressioni max riportate in tabella si basano su risultati ottenuti da prove idrauliche utilizzando guarnizioni standard in Buna-U.

Per temperature superiori a 121 °C si raccomanda di utilizzare solo il clamp tipo 13MHP.

Service rating are based on hydrostatic tests using standard Buna-U gaskets. For temperature above 121 °C we recommend using only 13MHP clamp only.



size	A	B	C	Thk	code
1/2"	12,7	12,7	25,2	1,65	14WMP-1/2"
3/4"	19,05	12,7	25,2	1,65	14WMP-3/4"
1"	25,4	12,7	50,4	1,65	14WMP-1"
1 1/2"	38,1	12,7	50,4	1,65	14WMP-1 1/2"
2"	50,8	12,7	64,0	1,65	14WMP-2"
2 1/2"	63,5	12,7	77,4	1,65	14WMP-2 1/2"
3"	76,2	12,7	90,0	1,65	14WMP-3"
4"	101,6	15,8	118,8	2,11	14WMP-4"

code **14WMP**

Tronchetto a saldare corto - *Short Welding Ferrule*

Cod. BS14AM
ASME BPE-2002 compliant
BPE TABLE # DT-22



size	A	B	B-BPE	C	code
1/2"	12,7	28,0	44,5	25,2	L14AM7-1/2"
3/4"	19,05	28,0	44,5	25,2	L14AM7-3/4"
1"	25,4	28,6	44,5	50,4	L14AM7-1"
1 1/2"	38,1	28,6	44,5	50,4	L14AM7-1 1/2"
2"	50,8	28,6	57,2	64,0	L14AM7-2"
2 1/2"	63,5	28,6	57,2	77,4	L14AM7-2 1/2"
3"	76,2	28,6	57,2	90,0	L14AM7-3"
4"	101,6	28,6	57,2	118,8	L14AM7-4"

code **L14AM7**

Tronchetto a saldare per orbitale - *Orbital welding Ferrule*



size	A	B	C	Thk	code
6"	152,4	28,0	166,67	2,77	14WLMO-6"
8"	203,2	28,0	217,67	2,77	14WLMO-8"
10"	254,0	28,0	268,48	2,77	14WLMO-10"
12"	304,8	28,0	319,27	2,77	14WLMO-12"

code **14WLMO**

Tronchetto a saldare per orbitale - *Orbital welding Ferrule*



size	A	B	C	Thk	code
1/2"	Not available				
3/4"	Not available				
1"	25,4	76,2	50,4	1,65	14WLMP-1"
1 1/2"	38,1	76,2	50,4	1,65	14WLMP-1 1/2"
2"	50,8	76,2	64,0	1,65	14WLMP-2"
2 1/2"	63,5	76,2	77,4	1,65	14WLMP-2 1/2"
3"	76,2	101,6	90,0	1,65	14WLMP-3"
4"	101,6	101,6	118,8	2,11	14WLMP-4"

code **14WLMP**

Tronchetto a saldare lungo - *Long Welding Ferrule (Light)*

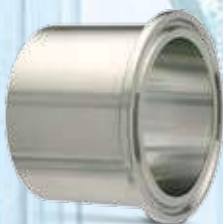

size	A	B	C	Thk	code
1/2"	Not available				
3/4"	Not available				
1"	29,5	41,3	50,4	3,85	14MPW-1"
1 1/2"	42,6	41,3	50,4	4,05	14MPW-1 1/2"
2"	55,7	44,4	64,0	4,25	14MPW-2"
2 1/2"	68,8	44,4	77,4	4,45	14MPW-2 1/2"
3"	81,9	46,0	90,0	4,65	14MPW-3"
4"	108,1	54,0	118,8	5,65	14MPW-4"

code **14MPW**

Tronchetto a saldare spessorato - *Welding Ferrule (Heavy)*

Cod. B2CMP-90°
ASME BPE-2002
compliant
BPE TABLE
DT-16

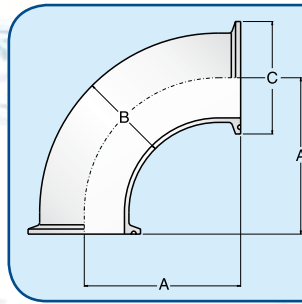

size	A	B	C	A-BPE	code
1/2"			25,2	41,3	2CMP-90-1/2"
3/4"			25,2	41,3	2CMP-90-3/4"
1"	50,8	25,4	50,4	50,8	2CMP-90-1"
1 1/2"	69,9	38,1	50,4	69,9	2CMP-90-1 1/2"
2"	88,9	50,8	64,0	88,9	2CMP-90-2"
2 1/2"	108,0	63,5	77,4	108,0	2CMP-90-2 1/2"
3"	127,0	76,2	90,0	127,0	2CMP-90-3"
4"	168,3	101,6	118,8	168,3	2CMP-90-4"

code **2CMP - 90° ELL**

Curva clamp 90° - 90°Elbow clamp ends

Cod. B2KMP-45°
ASME BPE-2002 compliant
BPE TABLE # DT-17

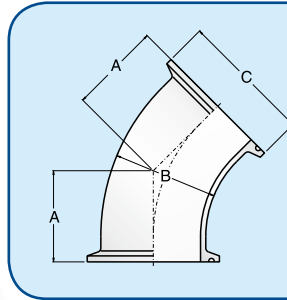

size	A	B	C	A-BPE	code
1/2"			25,2	25,4	2KMP-45-1/2"
3/4"			25,2	25,4	2KMP-45-3/4"
1"	28,6	25,4	50,4	28,6	2KMP-45-1"
1 1/2"	36,5	38,1	50,4	36,5	2KMP-45-1 1/2"
2"	44,5	50,8	64,0	44,5	2KMP-45-2"
2 1/2"	52,4	63,5	77,4	52,4	2KMP-45-2 1/2"
3"	60,3	76,2	90,0	60,3	2KMP-45-3"
4"	79,4	101,6	118,8	79,4	2KMP-45-4"

code **2KMP - 45° ELL**

Curva clamp 45° - 45°Elbow clamp ends

Cod. B7MP
ASME BPE-2002
compliant
BPE TABLE
DT-18

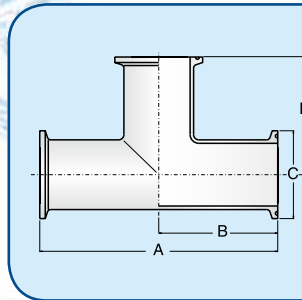

size	A	B	C	B-BPE	code
1/2"			25,2	57,2	7MP-1/2" - from bar
3/4"			25,2	60,3	7MP-3/4" - from bar
1"	120,6	60,3	50,4	66,7	7MP-1"
1 1/2"	139,8	69,9	50,4	73,0	7MP-1 1/2"
2"	177,8	88,9	64,0	85,7	7MP-2"
2 1/2"	177,8	88,9	77,4	92,1	7MP-2 1/2"
3"	190,6	95,5	90,0	98,4	7MP-3"
4"	228,6	114,3	118,8	120,7	7MP-4"

code **7MP**

Tee clamp - Tee clamp ends

Cod. B7RMP
ASME BPE-2002 compliant
BPE TABLE # DT-19

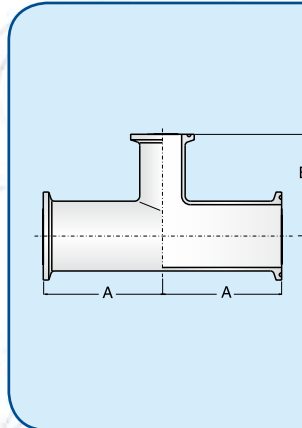

size	A	B	A-BPE	B-BPE	code
1"x3/4"			66,7	66,7	7RMP-1"1/2x3/4"
1 1/2"x1"	69,9	66,7	73,0	73,0	7RMP-1"1/2x1"
2"x1"	88,9	66,7	85,7	79,4	7RMP-2"x1"
2"x1 1/2"	88,9	76,2	85,7	79,4	7RMP-2"x1 1/2"
2 1/2"x1 1/2"	88,9	82,6	92,1	85,7	7RMP-2 1/2"x1 1/2"
2 1/2"x2"	88,9	95,3	92,1	85,7	7RMP-2 1/2"x2"
3"x1 1/2"	95,3	88,9	98,4	92,1	7RMP-3"x1 1/2"
3"x2"	95,3	101,6	98,4	98,4	7RMP-3"x2"
3"x2 1/2"	95,3	95,3	98,4	98,4	7RMP-3"x2 1/2"
4"x2"	114,3	114,3	120,7	111,1	7RMP-4"x2"
4"x2 1/2"	114,3	104,8	120,7	111,1	7RMP-4"x2 1/2"
4"x3"	114,3	104,8	120,7	111,1	7RMP-4"x3"

code **7RMP-TC**

Tee clamp ridotto - Reducing tee clamp ends

Cod. B9MP
ASME BPE-2002
compliant
BPE TABLE
DT-18

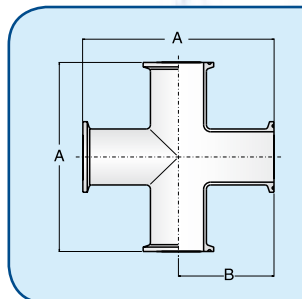

size	A	B	A-BPE	B-BPE	code
1/2"			114,4	57,2	9MP-1/2" - from bar
3/4"			120,6	60,3	9MP-3/4" - from bar
1"	133,4	66,7	133,4	66,7	9MP-1"
1 1/2"	146,0	73,0	146,0	73,0	9MP-1 1/2"
2"	177,8	88,9	171,4	85,7	9MP-2"
2 1/2"	177,8	88,9	184,2	92,1	9MP-2 1/2"
3"	190,6	95,3	196,8	98,4	9MP-3"
4"	228,6	114,3	241,4	120,7	9MP-4"

code **9MP**

Croce clamp - Cross clamp ends

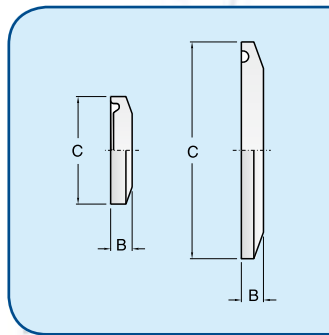

size	B	C	code
1/2" - 3/4"	25,2	4,7	16AMP-3/4"
1" - 1 1/2"	50,4	6,4	16AMP-1" 1/2"
2"	63,9	6,4	16AMP-2"
2 1/2"	77,4	6,4	16AMP-2" 1/2"
3"	90,9	6,4	16AMP-3"
4"	118,9	6,4	16AMP-4"
6"	166,9	11,1	16AMP-6"
8"	217,7	11,1	16AMP-8"
10"	268,5	14,3	16AMP-10"
12"	319,3	14,3	16AMP-12"

code **16AMP**

Tappo clamp cieco - *Clamp solid end cap*

code **31-14MP**

Riduzione concentrica clamp - *Concentric reducer clamp ends*



Cod. B31/32 14MP
ASME BPE-2002 compliant
BPE TABLE # DT-21

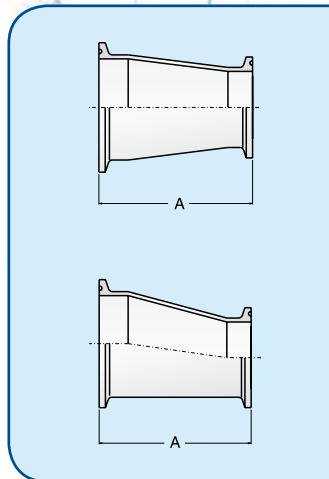

size	A	A-BPE	code
3/4" x 1/2"	50,8	50,8	31/32-14MP-3/4" x 1/2"
1" x 1/2"	63,5	63,5	31/32-14MP-1" x 1/2"
1" x 3/4"	50,8	50,8	31/32-14MP-1" x 3/4"
1 1/2" x 3/4"	76,2	76,2	31/32-14MP-1 1/2" x 3/4"
1 1/2" x 1"	76,2	76,2	31/32-14MP-1 1/2" x 1"
2" x 1"	127,0	127,0	31/32-14MP-2" x 1"
2" x 1 1/2"	76,2	76,2	31/32-14MP-2" x 1 1/2"
2 1/2" x 1 1/2"	127,0	127,0	31/32-14MP-2 1/2" x 1 1/2"
2 1/2" x 2"	76,2	76,2	31/32-14MP-2 1/2" x 2"
3" x 1 1/2"	177,8	177,8	31/32-14MP-3" x 1 1/2"
3" x 2"	127,0	127,0	31/32-14MP-3" x 2"
3" x 2 1/2"	76,2	76,2	31/32-14MP-3" x 2 1/2"
4" x 2"	231,8	231,8	31/32-14MP-4" x 2"
4" x 2 1/2"	181,0	181,0	31/32-14MP-4" x 2 1/2"
4" x 3"	130,2	130,2	31/32-14MP-4" x 3"

code **32-14MP**

Riduzione eccentrica clamp - *Eccentric reducer clamp ends*



code **22MP**

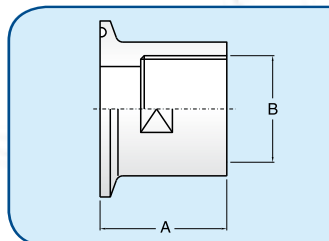

size	A	B	code
1/2"	Thread profile BSPP /Cylindrical gas B= ON REQUEST		
3/4"			
1"			
1 1/2"			
2"			
2 1/2"			
3"			
4"			

Adattatore femmina - *Female adapters (non 3A)*



code **21MP**

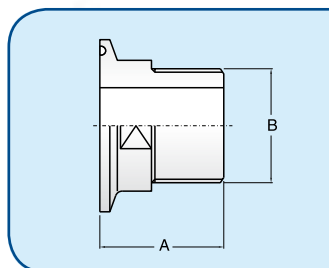

size	A	B	code
1/2"	Thread profile - BSPP /Cylindrical gas - BSPT /Conical gas - NPT B= ON REQUEST		
3/4"			
1"			
1 1/2"			
2"			
2 1/2"			
3"			
4"			

Adattatore maschio - *Male adapters (non 3A)*

BSPP/CYLINDRICAL GAS	BSPT/CONICAL GAS	NPT
<p>H = 0,9604 x Pitch h = 0,6403 x Pitch r = 0,1373 x Pitch</p>	<p>H = 0,9604 x Pitch h = 0,6403 x Pitch r = 0,1373 x Pitch conicalness = 6,25%</p>	<p>H = 0,866 x Pitch h = 0,800 x Pitch conicalness = 6,25%</p>

THREAD PROFILE

Ask for sizes not shown in this brochures.

Sanitary Clamp Gaskets

All clamp gaskets compounds meet the criteria of the FDA, and some compound formulations have also been certified and accepted by the USDA, 3-A Sanitary Standard, and USP Class VI certifications.

codice	materiale	size
42MP-U	BUNA	1/2" e 3/4"
42MP-X	SILICONE	1/2" e 3/4"
42MP-E	EPDM	1/2" e 3/4"
42MP-G	PTFE	1/2" e 3/4"
42MP-SFY	VITON	1/2" e 3/4"

tipo FRACTIONAL

cod. **42MP**

Guarnizione disponibile in due misure: 1/2" e 3/4"

Tipo più comunemente usato ed economico. È disponibile da 1/2" a 12".

Standard-Molded, one piece O-ring Gasket is economical, dependable. Available from stock 1/2" ÷ 12".

codice	materiale	size
40MP-U	BUNA	1" @ 4"
40MP-X	SILICONE	1" @ 4"
40MP-E	EPDM	1" @ 4"
40MP-G	PTFE	1" @ 12"
40MP-SFY	VITON	1" @ 4"

tipo 1

cod. **40MP**

Guarnizione standard in un solo pezzo tipo economico

Tipo flangiato per essere tenuto in posizione. È disponibile da 1" a 12".

Flanged-Molded, flanged O-ring Gasket with special snap-on rim design. Fits snugly and stays in position. Available from stock 1" ÷ 12".

codice	materiale	size
40MPF-X	SILICONE	1" @ 12"
40MPF-E	EPDM	1" @ 12"
40MPF-SFY	VITON	1" @ 12"

tipo 2

cod. **40MPF**

Guarnizione a labbro autocentrante

Tipo con rivestimento esterno in TEFLON e inserzione di VITON. È disponibile da 1" a 4".

Envelope Gasket has teflon outer jacket with a V-envelope type section to sandwich a VITON rubber insert. Available from stock 1" ÷ 4".

codice	materiale	size
A40MP-GR	PTFE+VITON	1" @ 4"

tipo 3

cod. **A40MP-GR**

Guarnizione in VITON rivestita esternamente in PTFE

Normalmente utilizzate per la realizzazione di dischi calibrati.

Normally used for prepare flange orifice.

codice	materiale	size
A80MP-G	PTFE	3/4" @ 2"

tipo SOLID

cod. **A80MP-G**

Guarnizione in PTFE cieca

Type 316 Stainless steel 0,023 dia. wire width of opening 0,75 inches between wires.

codice	materiale	size
A40MP-US-E	EPDM	1" @ 4"
A40MP-US-SFY	VITON	1" @ 4"
A40MP-US-X	SILICONE	1" @ 4"

tipo SCREEN GASKET

cod. **40MP-US**

Reti filtranti

PERFORMANCE PROPERTIES

Property	Nitrile(Bruna-U)	Ethylene-Propylene (EPDM-E)	Silicone (X)	Fluoroelastomer (Viton®-SFY)	Teflon® PTFE (G)
Tensile Strength	Fair-Good	Good-Excellent	Good	Good-Excellent	Excellent
Electrical Properties	Poor	Excellent	Excellent	Good	Excellent
Weather Resistance	Good	Excellent	Excellent	Good	Excellent
Ozone Resistance	Fair	Excellent	Excellent	Excellent	Excellent
Heat Resistance	Good (99 °C)	Excellent (149 °C)	Excellent (232 °C)	Excellent (177 °C)	Excellent (232 °C)
Cold Resistance	Fair-Good (-54 °C)	Good-Excellent (-51 °C)	Excellent (-62 °C)	Good (-29 °C)	Fair (-40 °C)
Steam Resistance	Good	Good	Poor	Good	Excellent
Tear Resistance	Good	Good	Excellent	Fair	Excellent
Abrasion	Good	Good-Excellent	Good-Excellent	Good	Excellent
Acid Resistance	Good	Good-Excellent	Good	Good	Excellent
Petroleum Oil	Excellent	Poor	Good	Excellent	Excellent
Flame Resistance	Poor	Poor	Poor	Good	Excellent
Vegetable Oil	Good	Good (Most)	Good (Intermittent)	Excellent	Excellent

**Buna-N is not recommended for use with CIP Sanitizing Agent OXONIA; use EPDM or Silicone.
Silicone-X is not recommended for use with glicerina.**

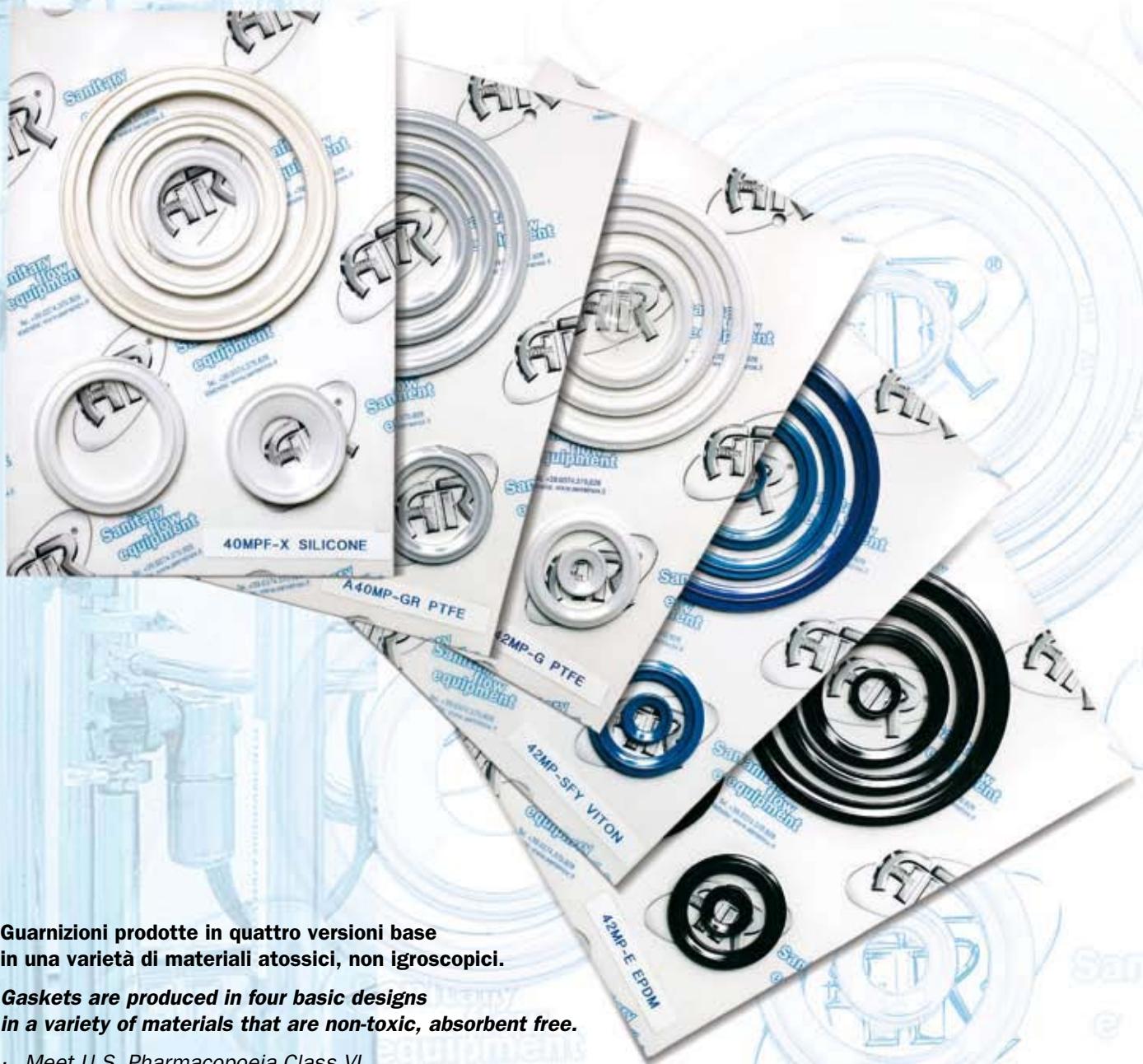

Guarnizioni prodotte in quattro versioni base in una varietà di materiali atossici, non igroscopici.

Gaskets are produced in four basic designs in a variety of materials that are non-toxic, absorbent free.

- Meet U.S. Pharmacopoeia Class VI
- Comply with title 21 CFR 177.2600
- Comply with USDA and 3A sanitary standard

Weld ends fitting

ASME BPE-2002 COMPLIANT FITTINGS
available on request

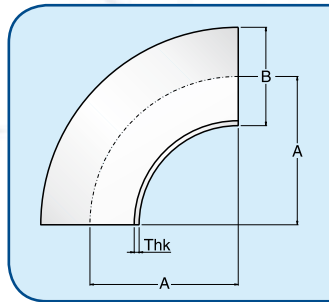

size	A	B	Thk	code
1/2"		12,7	1,65	2WCL-90-1/2"
3/4"		19,05	1,65	2WCL-90-3/4"
1"	38,1	25,4	1,65	2WCL-90-1"
1 1/2"	57,2	38,1	1,65	2WCL-90-1 1/2"
2"	76,2	50,8	1,65	2WCL-90-2"
2 1/2"	95,3	63,5	1,65	2WCL-90-2 1/2"
3"	114,3	76,2	1,65	2WCL-90-3"
4"	152,4	101,6	2,11	2WCL-90-4"

code **2WCL - 90 °**

Curva saldare 90 ° - 90 ° Elbow weld ends

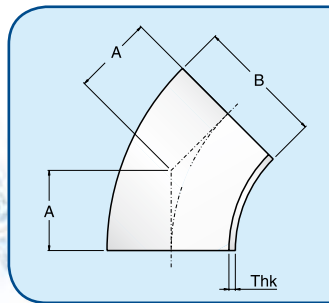

size	A	B	Thk	code
1/2"		12,7	1,65	2WK-45-1/2"
3/4"		19,05	1,65	2WK-45-3/4"
1"	15,9	25,4	1,65	2WK-45-1"
1 1/2"	23,8	38,1	1,65	2WK-45-1 1/2"
2"	31,8	50,8	1,65	2WK-45-2"
2 1/2"	39,7	63,5	1,65	2WK-45-2 1/2"
3"	47,6	76,2	1,65	2WK-45-3"
4"	63,5	101,6	2,11	2WK-45-4"

code **2WK - 45 °**

Curva saldare 45 ° - 45 ° Elbow weld ends

Cod. B2S- 90 °
ASME BPE-2002 compliant
BPE TABLE # DT-7

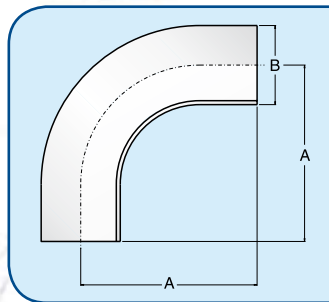

size	A	A-BPE	B	code
1/2"		76,2	12,7	L2S-90-1/2"
3/4"		76,2	19,05	L2S-90-3/4"
1"	52,4	76,2	25,4	L2S-90-1"
1 1/2"	74,6	95,3	38,1	L2S-90-1 1/2"
2"	103,2	120,7	50,8	L2S-90-2"
2 1/2"	131,8	139,7	63,5	L2S-90-2 1/2"
3"	160,3	158,8	76,2	L2S-90-3"
4"	211,1	203,2	101,6	L2S-90-4"

code **L2S - 90 °**

Curva saldare in orbitale 90 ° - 90 ° Tube bend

Cod. B2KS- 45 °
ASME BPE-2002 compliant
BPE TABLE # DT-8

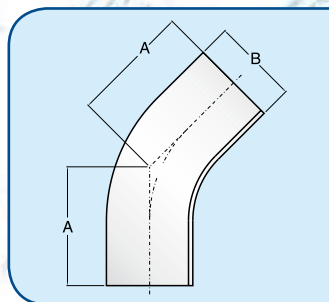

size	A	A-BPE	B	code
1/2"		57,2	12,7	L2KS-45-1/2"
3/4"		57,2	19,05	L2KS-45-3/4"
1"	30,2	57,2	25,4	L2KS-45-1"
1 1/2"	41,3	63,5	38,1	L2KS-45-1 1/2"
2"	58,7	76,2	50,8	L2KS-45-2"
2 1/2"	76,2	85,7	63,5	L2KS-45-2 1/2"
3"	93,7	92,1	76,2	L2KS-45-3"
4"	122,2	114,3	101,6	L2KS-45-4"

code **L2KS - 45 °**

Curva saldare in orbitale 45 ° - 45 ° Tube bend

Cod. B7WWW
ASME BPE-2002 compliant
BPE TABLE # DT-9

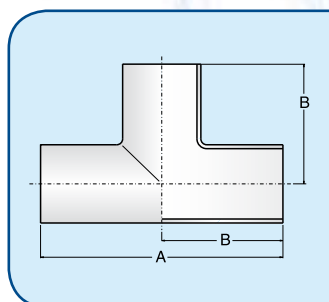

size	A	B	A-BPE	B-BPE	code
1/2"			95,2	47,6	7WWW-1/2"
3/4"			101,6	50,8	7WWW-3/4"
1"	95,2	47,6	108,0	54,0	7WWW-1"
1 1/2"	114,4	57,2	120,6	60,3	7WWW-1 1/2"
2"	152,4	76,2	146,0	73,0	7WWW-2"
2 1/2"	152,4	76,2	158,8	79,4	7WWW-2 1/2"
3"	165,2	82,6	171,4	85,7	7WWW-3"
4"	196,8	98,4	209,6	104,8	7WWW-4"

code **7WWW**

Tee a saldare - Tee welds ends

Cod. B7RWWW
ASME BPE-2002 compliant
BPE TABLE # DT-10

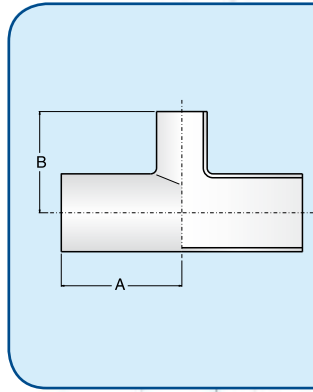

size	A	B	A-BPE	B-BPE	code
1"x 3/4"			54,0	54,0	7RWWW-1"1/2x3/4"
1"1/2 x 1"	57,2	54,0	60,3	60,3	7RWWW-1"1/2 x 1"
2" x 1"	76,2	60,3	73,0	66,7	7RWWW-2" x 1"
2" x 1"1/2	76,2	63,5	73,0	66,7	7RWWW-2" x 1"1/2
2"1/2 x 1"1/2	76,2	69,9	79,4	73,0	7RWWW-2"1/2x1"1/2
2"3/4 x 2"	76,2	82,6	79,4	73,0	7RWWW-2"1/2x2"
3" x 1"1/2	82,6	76,2	85,7	79,4	7RWWW-3" x 1"1/2
3" x 2"	82,6	88,9	85,7	79,4	7RWWW-3" x 2"
3" x 2"1/2	82,6	82,6	85,7	79,4	7RWWW-3" x 2"1/2
4" x 2"	98,4	101,6	104,8	98,4	7RWWW-4" x 2"
4" x 2"1/2	98,2	95,3	104,8	98,4	7RWWW-4" x 2"1/2
4" x 3"	98,2	95,3	104,8	98,4	7RWWW-4" x 3"

code **7RWWW**

Tee ridotto a saldare - Reducing tee weld ends

Cod. B9WWW
ASME BPE-2002 compliant
BPE TABLE # DT-9

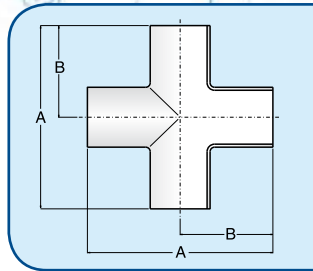

size	A	B	A-BPE	B-BPE	code
1/2"			95,2	47,6	9WWW-1/2"
3/4"			101,6	50,8	9WWW-3/4"
1"	95,2	47,6	108,0	54,0	9WWW-1"
1"1/2	114,4	57,2	120,6	60,3	9WWW-1"1/2
2"	152,4	76,2	146,0	73,0	9WWW-2"
2"1/2	152,4	76,2	158,8	79,4	9WWW-2"1/2
3"	165,2	82,6	171,4	85,7	9WWW-3"
4"	196,8	98,4	209,6	104,8	9WWW-4"

code **9WWW**

Croce a saldare - Cross weld ends

code **31W**

Riduzione concentrica a saldare - Concentric reducer weld ends

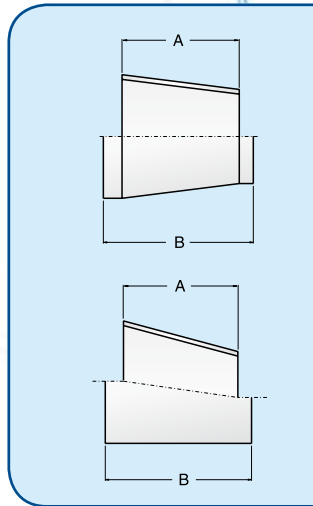

size	A	B-BPE	code
3/4" x 1/2"		101,6	31/32W-3/4" x 1/2"
1" x 1/2"		114,3	31/32W-1" x 1/2"
1" x 3/4"		101,6	31/32W-1" x 3/4"
1"1/2 x 3/4"		127,0	31/32W-1"1/2x 3/4"
1"1/2 x 1"	50,8	127,0	31/32W-1"1/2x 1"
2" x 1"	101,6	184,2	31/32W-2" x 1"
2" x 1"1/2	50,8	133,4	31/32W-2" x 1"1/2
2"1/2 x 1"		235,0	31/32W-2"1/2x1"
2"1/2 x 1"1/2		184,2	31/32W-2"1/2x1"1/2
2"1/2 x 2"	50,8	139,7	31/32W-2"1/2x2"
3" x 1"1/2	152,4	235,0	31/32W-3" x 1"1/2
3" x 2"	101,6	190,5	31/32W-3" x 2"
3" x 2"1/2	50,8	139,7	31/32W-3" x 2"1/2
4" x 2"	203,2	298,5	31/32W-4" x 2"
4" x 2"1/2	152,4	247,7	31/32W-4" x 2"1/2
4" x 3"	101,6	196,9	31/32W-4" x 3"

code **32W**

Riduzione eccentrica a saldare - Eccentric reducer weld ends

code **14MPHR**

Portagomma clamp - Clamp rubber hose

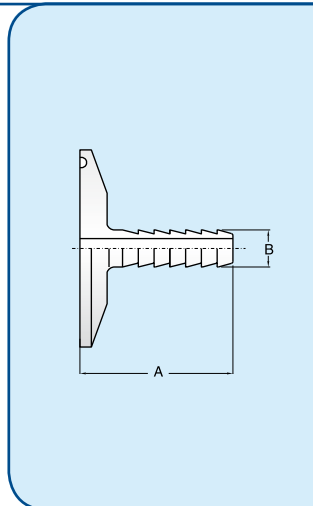

size	A	B	code
1/2"	28,0	12,7	14MPHR-1/2"
3/4"	32,0	19,05	14MPHR-3/4"
1"	45,0	25,4	14MPHR-1"
1"1/2	45,0	38,1	14MPHR-1"1/2
2"	60,0	50,8	14MPHR-2"
2"1/2	65,0	63,5	14MPHR-2"1/2
3"	80,0	76,2	14MPHR-3"
4"	90,0	101,6	14MPHR-4"
size	A	B available	code
1/2"	28,0	5-6-7-8-9	14MPHRS-1/2"
		10-12-12,7-13,7	
1"	38,0	6-7-8-9-10-12,7	14MPHRS-1"
		13,7-17-19-21,3	
1"1/2	38,0	30-32-40	14MPHRS-1"1/2
2"	38,0	6-7-8-9-10-12,7-13,7-17-19	14MPHRS-2"
		21,3-25,4-30-32-38,1-40	

code **14MPHRS**

Portagomma clamp speciali - Special clamp rubber hose

Ask for sizes not shown in this brochures.

SPECIALTY ITEMS

К-ТЕП — Фитинги Clamp

<http://k-tep.com.ua/>

✉ k-tep@ukr.net

■ Office +38 044 2091823

■ МТС +38 066 9076563

■ Киевстар +38 098 3676414

Skype: [k-teppumps](#)



Замечания

Условия поставки: DDP склад г. Киев

Заметки

Время поставки рассчитано согласно дате предложения и изменяется в зависимости от даты подтверждения заказа.

Размещая заказ, покупатель принимает предложение и все спецификации, характеристики и условия, указанные в данном документе.